

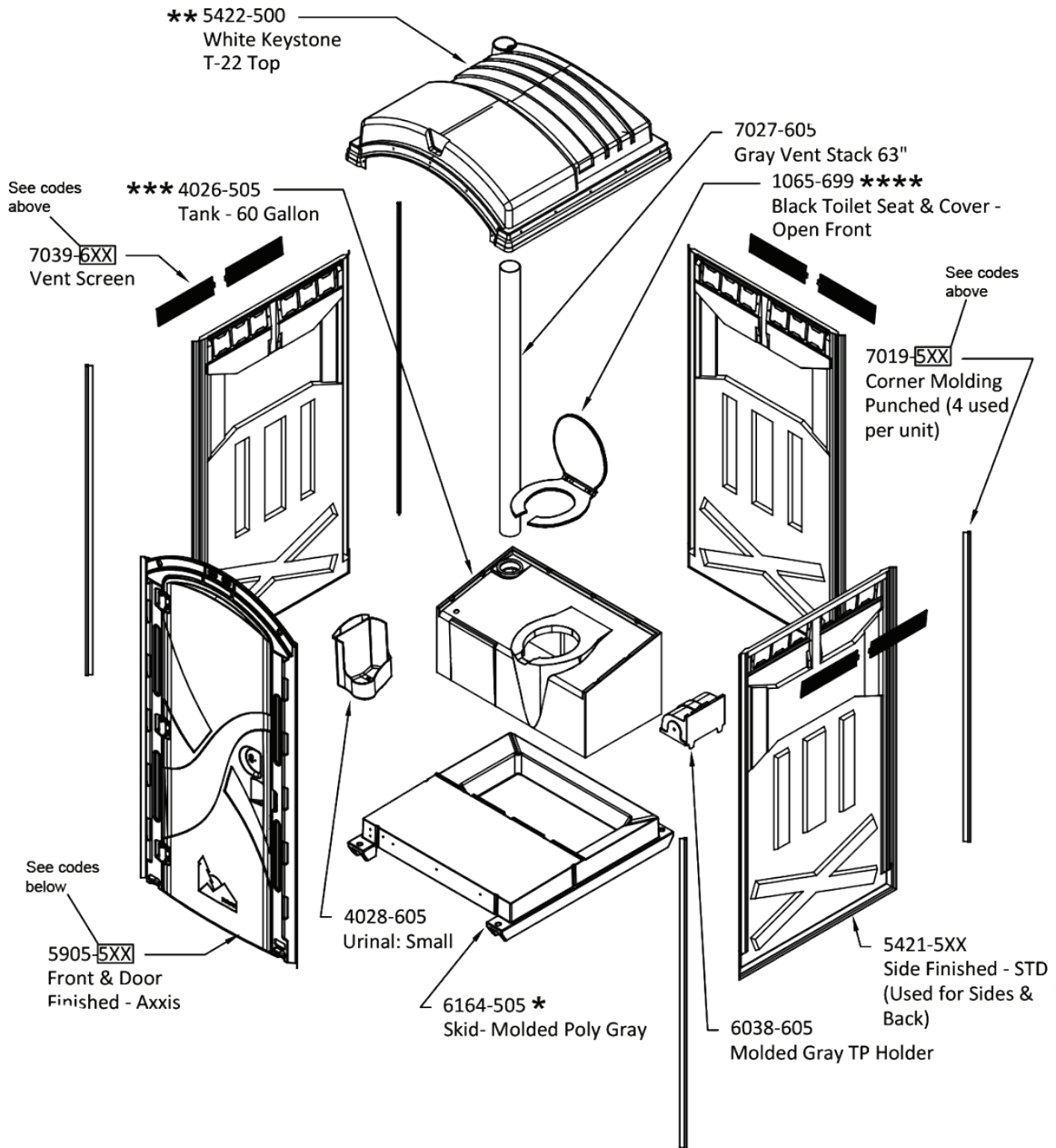

2019 parts catalog

AXXIS® MAJOR ASSEMBLY (POLYPORTABLES)



AXXIS® COLOR CHART

	Aqua	Blue	Gray	Green	Lime	Orange	Pink	Red
Front Part #	01	03	05	06	08	09	10	11
Panel Part #	01	03	05	06	08	09	10	11
	Silver	Tan	Maroon	Yellow	Turbo Blue	Dark Blue	Grass Green	Purple
Front Part #	12	12	14	17	21	24	26	27
Panel Part #	12	12	14	17	21	24	26	27

AXXIS® ASSEMBLY (POLYPORTABLES)

PART#	QPU	DESCRIPTION	PRICE
Front and Door Assembly			
5905-503	1	Blue Front & Door Finished-AXXIS	
1808-699	2	Rivet: 688 Tri-Bulb (coat hook, mirror, slide latch bracket)	
1080-699	1	Door / Hover Handle - Vantage / AXXIS	
1021-699	3	Hinge: Spring Loaded	
1827-699	12	Rivet: SSB68S (spring hinge)	
1701-699	12	Washer: .1951D x .625 OD x .060 SS Backer Washer	
1081-799-99V	1	Rotary Door Latch with Complete for AXXIS or Vantage Unit	
1081-799	1	Rotary Door Latch with Label	
1934-699	1	Screw: Shoulder Screw 1/4" D x 2" L Shoulder, 10-24 Thread, SS	
1713-699	1	Washer: 1/4" Stainless Flat	
1771-699	1	Nut: 10-24 Hex SS,Nylon Insert Lock Nut 3/8" x 15/64 High for Rotary Latch	
1705-699	1	Washer: Aluminum 3/16	
1093-699-99	1	Axxis/Vantage Lock Bracket - Complete	
1093-699	2	Lock Bracket (AXXIS)	
1808-699	4	Rivet: 688 Tri-Bulb (coat hook, mirror, slide latch bracket)	
Slide Assembly			
5421-503-99	3	Blue Side - Complete	
1816-699	21	Rivet: ABL66A (corners, urinal, TP cover, vent screens)	
1705-699	23	Washer: Aluminum 3/16	
1813-699	2	Rivet: ABL610A (for bottom of corners, door latch bracket)	
1923-699	5	Screw: Lag 1/4 X 1 1/2 for Std. Unit	
1709-699	5	Washer: White plastic 1/4 x 1.25	
7019-500-99	4	Corner Molding White - Complete	
1816-699	8	Rivet: ABL66A (corners, urinal, TP cover, vent screens)	
1705-699	9	Washer: Aluminum 3/16	
1813-699	1	Rivet: ABL610A (for bottom of corners, door latch bracket)	
7039-600-99	6	White Vent Screen - Complete	
1816-699	2	Rivet: ABL66A (corners, urinal, TP cover, vent screens)	
1705-699	2	Washer: Aluminum 3/16	
Top Assembly			
5424-500-99	1	White Standard T-11 Top - Complete / Integra	
1816-699	15	Rivet: ABL66A (corners, urinal, TP cover, vent screens)	
1705-699	15	Washer: Aluminum 3/16	
1817-699	5	Rivet: BF41-0625 Tri Clamp (for front of Keystone top)	
5422-500-99	1	White Keystone T-22 Top - Complete	
1816-699	15	Rivet: ABL66A (corners, urinal, TP cover, vent screens)	
1705-699	15	Washer: Aluminum 3/16	
1817-699	5	Rivet: BF41-0625 Tri Clamp (for front of Keystone top)	

AXXIS® MAJOR ASSEMBLY (POLYPORTABLES)

PART#	QPU	DESCRIPTION	PRICE
Internal Components			
6037-605-99	1	Molded Gray 3 Roll TP Holder ^(New Style) - Complete	
1816-699	4	Rivet: ABL66A (corners, urinal, TP cover, vent screens)	
1705-699	4	Washer: Aluminum 3/16	
1051-699	1	Toilet Paper Rod for 3 ROLL TP Holder ^(Black)	
1038-699	1	Padlock With Key	
1029-699-99	1	Coat Hook - Complete	
1808-699	2	Rivet: 688 Tri-Bulb ^(coat hook, mirror, slide latch bracket)	
4028-605-99	1	Urinal: Small - Complete	
1816-699	2	Rivet: ABL66A (corners, urinal, TP cover, vent screens)	
1705-699	2	Washer: Aluminum 3/16	
7027-605-99	1	Gray Vent Stack 63" - Complete	
1814-699	1	Rivet: ABL0640 ^(vent stack)	
4028-605-99	1	Urinal: Small - Complete	
1816-699	2	Rivet: ABL66A (corners, urinal, TP cover, vent screens)	
1705-699	2	Washer: Aluminum 3/16	
4136-605-99	1	Urinal: Offset - Complete for Integra/Standard Installation	
1815-699	3	Rivet: ABL612A (tank)	
1705-699	3	Washer: Aluminum 3/16	
1033-699-99	1	Mirror 6" x 8" Stainless Steel - Complete	
1808-699	4	Rivet: 688 Tri-Bulb ^(coat hook, mirror, slide latch bracket)	
Internal Components			
6164-605-99A	1	Base: Gray Molded - Complete / AXXIS ^(Includes front hardware only)	
1923-699	6	Screw: Lag 1/4 X 1 1/2 for Std. Unit	
1713-699	6	Washer: 1/4" Stainless Flat	
4026-605-99	1	Tank: 60-gal - Standard (no seat) - Complete	
1815-699	7	Rivet: ABL612A ^(tank)	
1705-699	7	Washer: Aluminum 3/16	
1065-699	1	Black Toilet Seat & Cover - Open Front	

AXXIS TOILET SPECIFICATIONS

HEIGHT STANDARD ROOF: 89" (2260MM)	STANDARD TANK VOLUME: 60 GAL (227L)
HEIGHT KEYSTONE ROOF: 92" (2336MM)	FLOOR SPACE: 41"-21" (1041MM X 533MM)
LENGTH: 47" (1194MM)	SEAT HEIGHT: 18" (457MM)
WIDTH: 43" (1092MM)	DOOR SPACING: 73" X 24" (1854MM) X 610MM)
WEIGHT (ROTO BASE): 165 lbs (75kg)	

Can't Sleep?

Shop Online and Save 5%



satelliteindustries.com



Regional Managers & Territories



Northwest

John Sprenger

763-519-6544

johns@satelliteindustries.com



Northeast

Josh Carmichael

574-350-2162

joshuac@satelliteindustries.com



South Central

Matt McClure

763-519-6521

mmclure@satelliteindustries.com



Southwest

Tim White

763-519-6543

timw@satelliteindustries.com



Southeast

Gordy Hunt

763-519-6520

ghunt@satelliteindustries.com



Texas

Ryan Foley

763-519-6526

ryanf@satelliteindustries.com



West

Bryan Lowe

763-519-6540

blowe@satelliteindustries.com



North Central

Mark Elhardt

763-551-7230

marke@satelliteindustries.com



Québec

Adrian Tummel

+32/2-542-56-55

adriant@satelliteindustries.com



Mountain

Jeff Sprenger

763-519-6527

jsprenger@satelliteindustries.com



Great Lakes

Paul Jongert

763-519-6546

paulj@satelliteindustries.com

Strategic Account Manager

Ryan Anthony

763-519-6548

ryana@satelliteindustries.com

Online Ordering

satelliteindustries.com | safetfresh.com

Customer Service

Restrooms: 800-883-1123 | Fax: 800-328-3334
Safe-T-Fresh: 877-764-7297 | information@satelliteindustries.com